

Surge Isolation Transformer "SIT"

Thin  
type

PROTECTOR DEVICE  
FOR POWER SUPPLY



Integrates the power supply connection **Board** and  
SIT **Board** to save space, construction work, and cost.

Power supply boards  
For disaster prevention  
equipment

Power supply boards  
For communication  
equipment

Power supply boards  
For facilities equipment

# 引込盤と耐雷変圧器を一体化。

Integrates the power supply connection board and SIT

Advantage  
1

Pull-in method by protector device for power supply

### Good Point

Single housing allows for lower cost of equipment

No foundation work required for installation

No need for wiring work between the power supply connection board and the SIT board

Installation is possible even on a small site area. Reduction of grounding pole construction area

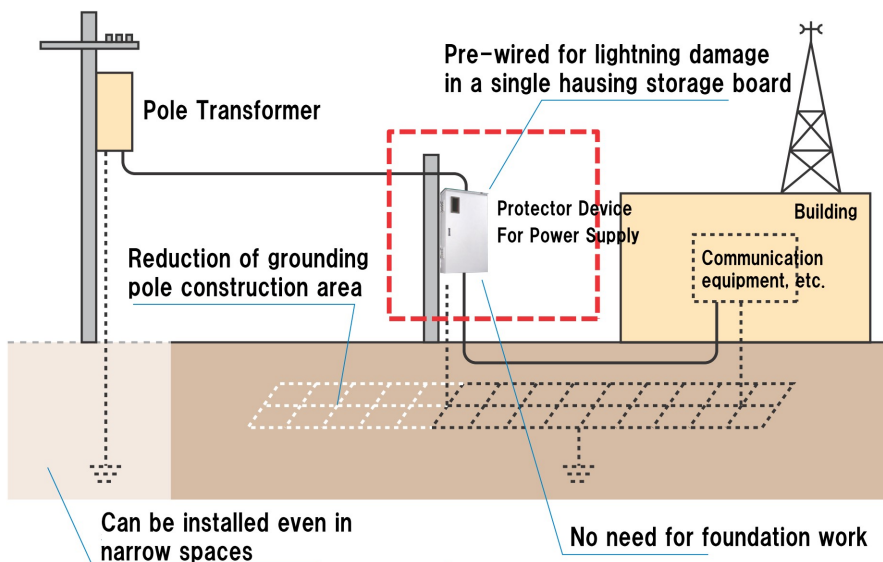

### Conventional pull-in method

### Bad Point

High cost due to the need for each the power supply connection board and the SIT board

Wiring must take lightning damage into account

Requires foundation work, high cost

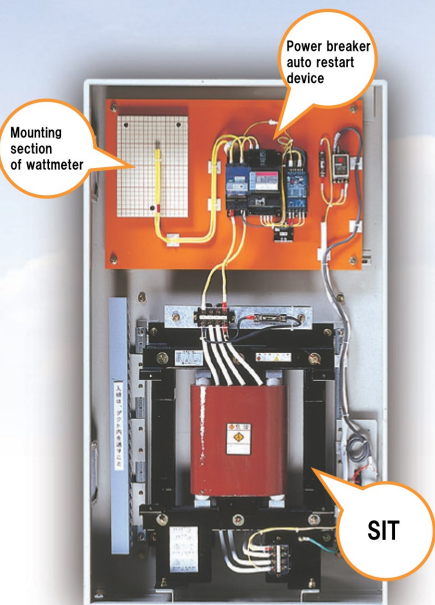
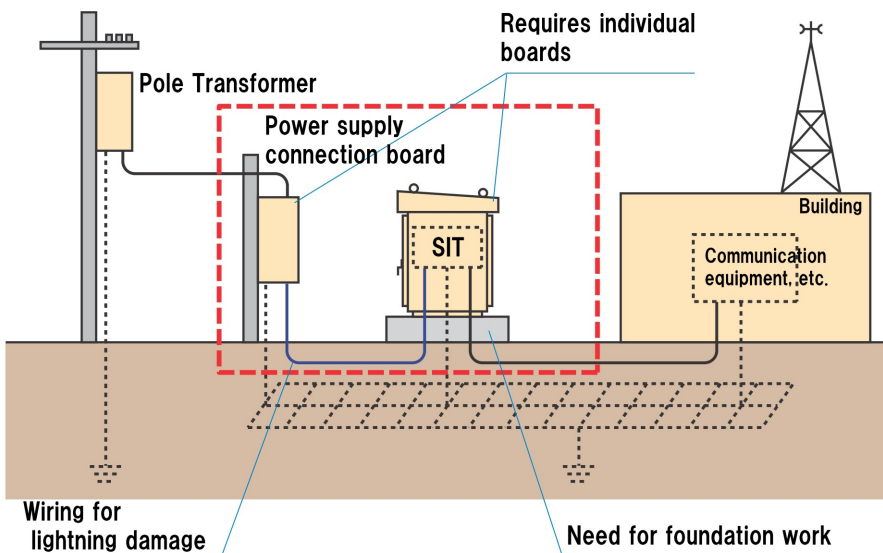



### Advantage 2

Thin and compact design realizes an integrated board

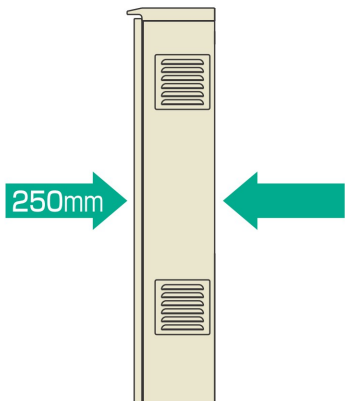

Achieves impulse withstand voltage of 30kVA with dimensions of 250mm deep

### Advantage 3

High surge protection capability based on many years of experience and technology.

■ Impulse withstand voltage is 30kV (1.2/50 μs) for the entire device including WHM

■ The surge migration rate is less than -60dB (1/1000) for the entire device including WHM

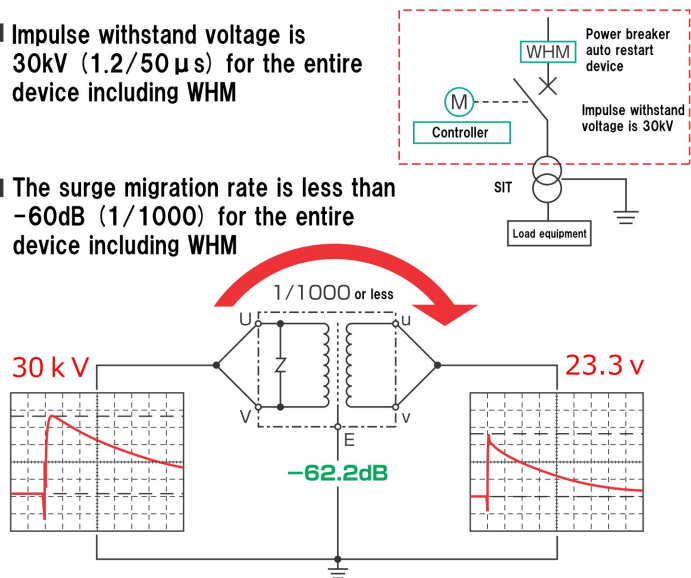

### Advantage 3

The power breaker auto restart device is employed

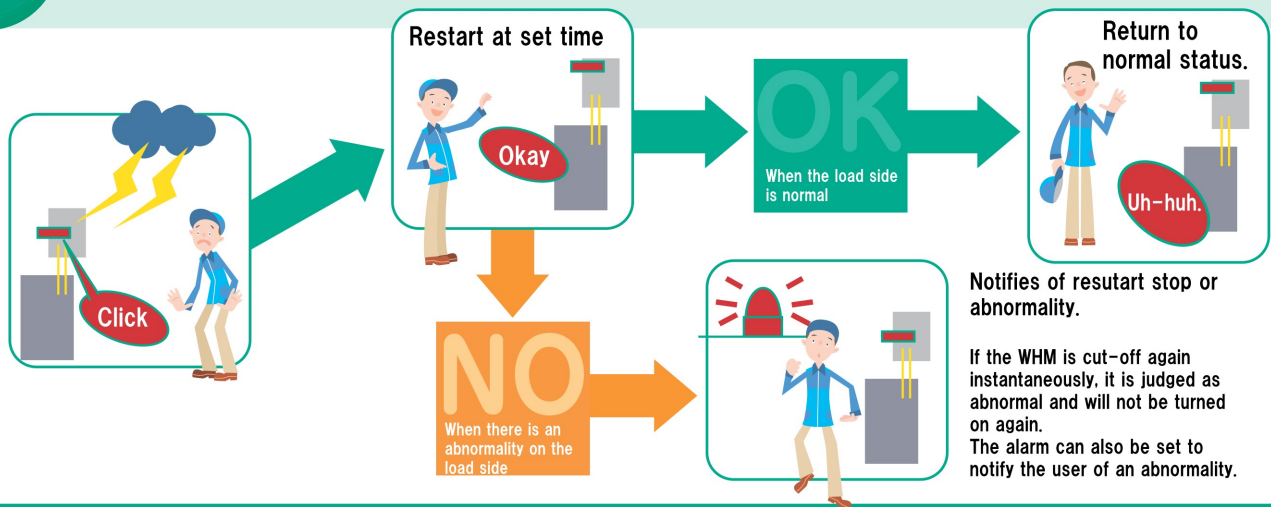

#### ■ Outline drawing (Unit [mm])

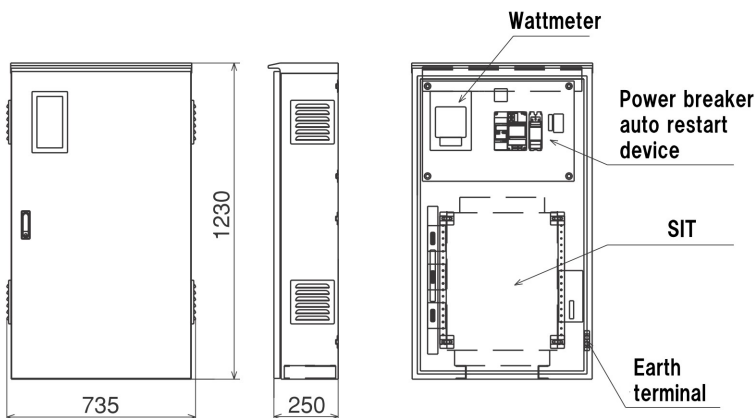

Total mass(ex.)125kg (5kVA) / 105kg (3kV)

#### ■ Main Specifications

Overall equipment specifications	
Number of phase	Single-phase
Phase and connection ( Voltage )	1 φ2W (200V) , 1 φ3W (200/100V)
Insulation strength	Between Input - output / earth
	10kV 1 minute
Lightning impulse withstand voltage	Between Input - output / earth
	3kV 1 minute
Surge transfer rate	30kV (1.2/50 μs)
	10kV (1.2/50 μs)
Usage environment	-60dB (1/1000) or less. ( common mode )
Usage environment	Temperature
	-10~40°C However, there must be no freezing.
Usage environment	Humidity
	85% or less. However, no dew condensation shall occur.

#### SIT specifications

SIT specifications	
Number of phase	Single-phase
Primary voltage	1 φ2W 200V (100V) serial-parallel conversion (200/100V) <sup>(Three-wire type can be manufactured)</sup>
Secondary voltage	1 φ2W 200V (100V) serial-parallel conversion (200/100V) <sup>(Three-wire type can be manufactured)</sup>
Rated capacity	5kVA or less
Insulation class	F

※ Production in excess of 5 kVA is also possible.



	<p><b>Safety Precautions</b> To ensure safe use of the products described in this catalog, be sure to read the instruction manual before installation, operation, maintenance, and inspection.</p>
--	--

 **TOYO ELECTRIC CORPORATION**  
**Transformer Business Unit**

**Head office/Kasugai Factory** 2-156 Ajiyoshi-cho, Kasugai-city, Aichi 486-8585 Japan  
Tel : +81-568-31-4191 Fax : +81-568-31-8096

**Tokyo Sales Office** Tokyo Section 3 Uchikanda Tosei Building 3F  
1-18-12 Uchikanda, Chiyoda-ku, Tokyo 101-0047 Japan  
Tel : +81-3-5382-3307 Fax : +81-3-5382-3309

**Nagoya Sales Office** Nagoya Section 3 2-156 Ajiyoshi-cho, Kasugai-city, Aichi 486-8585 Japan  
Tel : +81-568-33-5165 Fax : +81-568-35-0391

**Osaka Sales Office** Osaka Section 3 Asahi Seimei Doshomachi Building 5F,  
1-5-18 Doshomachi Chuou-ku, Osaka-city, Osaka 541-0045 Japan  
Tel : +81-6-6221-5362 Fax : +81-6-6221-5363

**KAGIYA Factory** 1-39 Hikusawa, Kagiya-cho, Kasugai-city, Aichi 480-0393 Japan  
Tel : +81-568-88-1700 Fax : +81-568-88-0701

\*Please note that the appearance of the listed products is subject to change without notice due to improvements or other reasons.

\*The color of the product may differ slightly from the actual product due to printing conditions.

■ For further information, please contact us.